



# IMAGINE HOMES



## Hot Climate, Production Home

In its "total commitment to market differentiation," production builder Imagine Homes is making a difference in the San Antonio region's new home market. The young company, which was founded on a dedication to responsible green building practices, has produced a home that was described by EVHA judges as an "excellent accomplishment." By creating a sealed attic design and implementing other air leakage control strategies, the company was able to achieve "extreme air leakage control in a production environment."

## Company Overview

Years in business: 5  
Average homes built per year: 77  
Member: Greater San Antonio Builders Association

## House Overview

Size: 3,670 s.f.  
Location: San Antonio, Texas  
Construction cost: \$48 per s.f.  
Completion date: June 2010

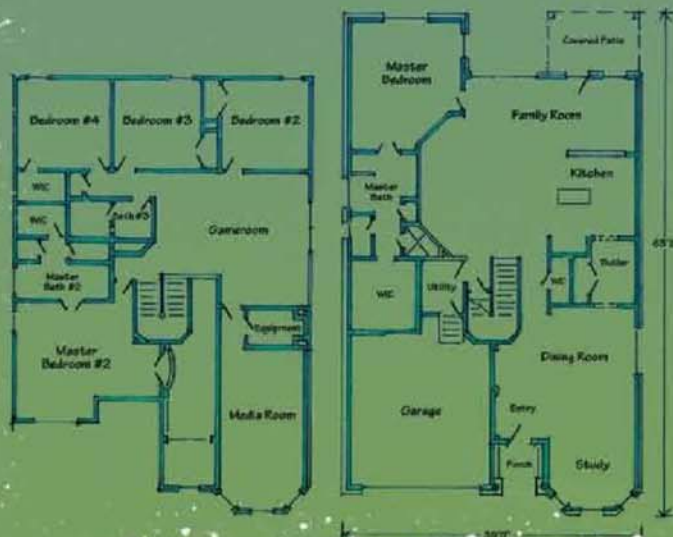

## Energy Features

Foundation: Uninsulated slab-on-grade  
Wall Construction: 2x6 at 24" o.c.; 2-stud corners and ladder blocking  
Wall Insulation: R-20 cellulose + R-3 foam sheathing  
Rim Joist Insulation: R-22 open cell foam  
Roof Construction: Unvented attic  
Ceiling Insulation: R-22 open cell foam at roofline  
Windows: Low-e vinyl windows; U-0.35, SHGC 0.22  
HVAC: 93 AFUE furnace; 17 SEER air conditioner; Central-fan-integrated passive fresh air supply ventilation  
Ducts: Manual D design; All in conditioned space; Multizone system  
Water Heating: 54 s.f. flat plate solar collector with 120-gallon storage tank and 0.85 EF electric auxiliary; PEX piping distribution  
Lighting: Whole-house lighting controls; 100% CFLs  
Appliances: ENERGY STAR refrigerator, dishwasher, and clothes washer  
On-Site Energy Generation: 2-kW photovoltaic system  
Duct Leakage Test: 98 cfm total at 25 Pa  
Blower Door Test: 933 cfm at 50; 1.2 ACH50  
HERS Index: 48 without/40 with PV  
Energy/Green Building Programs: Builders Challenge, ENERGY STAR, Build San Antonio Green